

 **MONSTER<sup>®</sup>**

**iCarCharger<sup>™</sup> AUX 1000**

**User Guide & Warranty Information**

## **iCarCharger™ AUX 1000**

- Charges iPod®/iPhone™ via 12V cigarette lighter
- 1/8" (3.5mm) audio jack plugs into car stereo's auxiliary input
- Uses iPod/iPhone dock connection for precise audio with minimal distortion
- Next/Previous Track and Playlist, Pause and Play controls on power adapter
- 3.28ft (1m) mini-jack (or line-in) cable with integrated storage to prevent clutter
- 24k gold contacts for maximum signal transfer

## Connecting iPod®/iPhone™ to the iCarCharger™ AUX 1000

Gently push on the cable storage sleeve on the iCarCharger AUX 1000 to reveal the cable wrap stem.

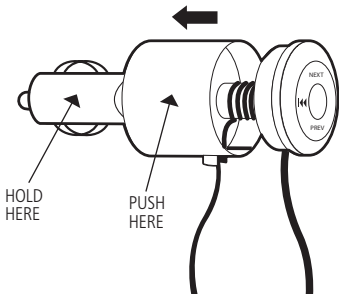

Unwind as much audio cable as needed to reach your car audio system's auxiliary in port from the cigarette lighter.

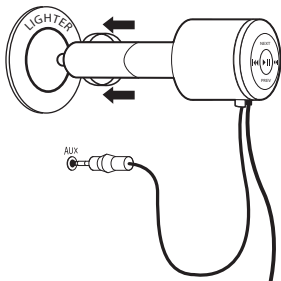

Replace the cable wrap cover, Being careful not to pinch the Audio Cable.

**IMPORTANT:** Make sure the audio cable passes through the cutout in the cable wrap cover.

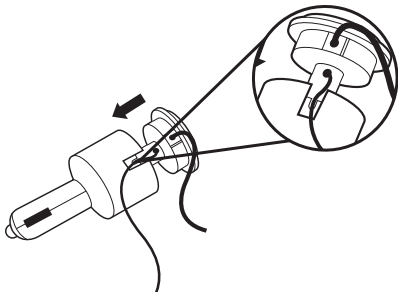

Insert the audio cable's 1/8" jack into your car's audio-in port.

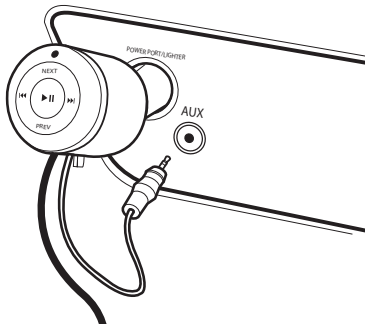

**NOTE:** The audio-in port in many vehicles is sometimes labeled AUX. The AUX port is sometimes located on the front of the car stereo, on the armrest/console between the driver and passenger front seats, or in the glove compartment. Refer to the vehicle or audio system manual.

Insert the iCarCharger™ AUX 1000 into the cigarette lighter, and adjust the angle for maximum convenience.

Connect your iPod®/iPhone™ to the iCarCharger's dock connector. The iCarChargerLED will illuminate to confirm power reception.

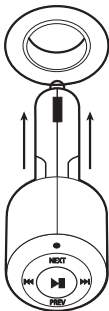

Press the Play button on iCarCharger AUX 1000 to initiate iPod/iPhone playback.

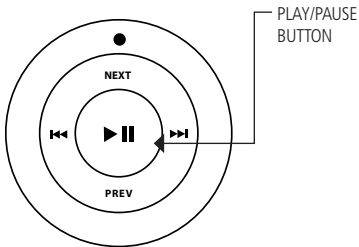

**NOTE:** To avoid unwanted sudden, loud noise, turn your car stereo volume to low to begin. Press play on iPod/iPhone, and then adjust volume on iPod/iPhone and stereo system, gradually increasing volume until a comfortable listening level is reached.

## **Controlling iPod®/iPhone™ with the iCarCharger™ AUX 1000**

Press left or right icons for Next/Previous track.

Press Next or Previous to change playlist.

Press center button to Pause or Play.

**NOTE:** iPod/iPhone can be put into Hold mode and the iCarCharger AUX 1000 will still retain full control capability.

## LIMITED WARRANTY FOR CONSUMERS

---

United States

Monster Cable Products, Inc., 455 Valley Drive, Brisbane, CA 94005, USA, (415) 840-2000 ("Monster") extends You this Limited Warranty. Statutory or common law may provide You with additional rights or remedies, which shall not be affected by this Limited Warranty.

### DEFINITIONS

---

**"Adequate Use"** means use of the Product (i) within a home or dwelling, (ii) for private (as opposed to commercial) purposes, (iii) in conformance with all applicable local, state or federal law, code or regulations (including without limitation building and/or electrical codes), (iv) in accordance with manufacturer recommendations and/or instructions in the materials and documentation that accompany the Product, and (v) if applicable, with proper electrical grounding.

**"Authorized Dealer"** means any distributor, reseller or retailer that (i) was duly authorized to do business in the

jurisdiction where it sold the Product to You, (ii) was permitted to sell You the Product under the laws of the jurisdiction where You bought the Product, and (iii) sold You the Product new and in its original packaging.

**“Formal Warranty Claim”** means a claim made in accordance with the section “Formal Warranty Claims” herein.

**“Product”** means a Product (i) that is listed in the Specifications Table below, (ii) that You bought from an Authorized Dealer new and in its original packaging, and (iii) whose serial number, if any, has not been removed, altered, or defaced.

**“Product Defect”** means an inadequacy of the Product that existed at the time when You received the Product from an Authorized Dealer and that causes a failure of the Product to perform in accordance with Monster’s documentation accompanying the Product, unless such failure has been caused completely or partly by (a) any use other than Adequate Use, (b)

transportation, neglect, misuse or abuse by anyone other than Monster's employees; (c) alteration, tampering or modification of the product by anyone other than a Monster employee; (d) accident (other than a malfunction that would otherwise qualify as a Product Defect); (e) maintenance or service of the Product by anyone other than a Monster employee; (f) exposure of the Product to heat, bright light, sun, liquids, sand or other contaminants; or (g) acts outside the control of Monster, including without limitation acts of God, fire, storms, earthquake or flood.

**“Warranty Period”** means the time period during which Monster must have received Your Formal Warranty Claim. The different Warranty Periods related to Product Defects are defined in the Specifications Table below. The Warranty Period commences on the date when You purchased or received (whichever occurs later) the Product from an Authorized Dealer as evidenced by the Authorized Dealer's invoice, sales receipt or packing slip. If You do not have written proof of the date

of purchase or receipt, then the Warranty Period commences three (3) months after the date when the Product left Monster's or its factory as evidenced by Monster's records. The Warranty Period ends after the time defined in the Specifications Table has expired or after You have transferred ownership of the Product, whichever occurs earlier. Also, You must call Monster and obtain a Return Authorization Number (as described under "How to Make a Claim") within two (2) months after You discover a Product Defect (or should have discovered it, if such Product Defect was obvious).

**"You"** means the first individual person that purchased the Product in its original packaging from an Authorized Dealer. This Limited Warranty does not apply to persons or entities that bought the Product (i) in used or unpackaged form, (ii) for resale, lease or other commercial use, or (iii) from someone other than an Authorized Dealer.

## SCOPE OF THIS LIMITED WARRANTY

---

**Products.** If a Product contained a Product Defect when You bought it from an Authorized Dealer and Monster receives a Formal Warranty Claim from You within two (2) months after You discover such Product Defect (or should have discovered it, if such Product Defect was obvious) and before the end of the Warranty Period for Product Defects applicable to the affected Product, then Monster will provide You with one of the following remedies: Monster will (1) repair or, at Monster's sole discretion, replace the Product, or (2) refund to You the purchase price You paid to the Authorized Dealer for the affected Product if repair or replacement is not commercially practicable or cannot be timely made. NOTE: MONSTER DOES NOT ASSUME ANY LIABILITY FOR ANY INCIDENTAL, CONSEQUENTIAL OR INDIRECT DAMAGES UNDER THIS LIMITED WARRANTY.

## GENERAL PROVISIONS

---

**CHOICE OF LAW/JURISDICTION.** This Limited Warranty and any disputes arising out of or in connection with this Limited Warranty (“Disputes”) shall be governed by the laws of the State of California, USA, excluding conflicts of law principles and excluding the Convention for the International Sale of Goods. The courts located in the State of California, USA shall have exclusive jurisdiction over any Disputes.

**OTHER RIGHTS.** THIS LIMITED WARRANTY GIVES YOU SPECIFIC LEGAL RIGHTS, AND YOU MAY ALSO HAVE OTHER RIGHTS, WHICH VARY FROM STATE TO STATE AND JURISDICTION TO JURISDICTION, AND WHICH SHALL NOT BE AFFECTED BY THIS LIMITED WARRANTY. THIS WARRANTY EXTENDS ONLY TO YOU AND CANNOT BE TRANSFERRED OR ASSIGNED. If any provision of this Limited Warranty is unlawful, void or unenforceable, that provision shall be deemed severable and shall not affect any remaining provisions. In case of any inconsistency between the English and other versions of this Limited Warranty, the English version shall prevail.

**REGISTRATION.** Please register Your Product at [www.monstercable.com](http://www.monstercable.com). Failure to register will not diminish Your warranty rights.

---

### **SPECIFICATIONS TABLE**

---

<b>Product Model No.</b>	<b>Warranty Period for Product</b>
--------------------------	------------------------------------

---

iCarCharger™ AUX 1000	One (1) Year
-----------------------	--------------

---

---

### **FORMAL WARRANTY CLAIM**

---

**HOW TO MAKE A CLAIM.** In the event damage has occurred to Products, You must follow these instructions: (1) Call Monster within two (2) months after You discover a Product Defect (or should have discovered it, if such Product Defect was obvious); (2) Give a detailed explanation of how the damage occurred; (3) Obtain a Return Authorization Number; (4) Upon receipt of a claim form (which may be sent to You after You filed Your Formal Warranty Claim), fill out the claim form entirely; (5) Return the Products, shipping

prepaid by You (to be refunded if You are entitled to a remedy under the Scope of this Limited Warranty), to Monster for verification of damage, along with a copy of Your original sales receipts and proof of purchase (UPC label or packing slip) for such Products, the completed claim form, and printed Return Authorization Number on the outside of the return package (the claim form will include instructions for return).

**TELEPHONE NUMBERS.** If you bought the product in the United States, Latin America, or Asia Pacific, contact Monster Cable Products, Inc. (455 Valley Drive, Brisbane, CA 94005) at 1 877 800-8989. If you bought the product anywhere else, contact Monster Cable International Ltd., Ballymaley Business Park, Ennis, Co. Clare, Ireland. You can write or use one of the following telephone numbers: Canada 866-348-4171, Ireland 353 65 68 69 354, Belgium 0800-79201, Czech Republic 800-142471, Denmark 8088-2128, Finland 800-112768, France 0800-918201, Germany 0800-1819388, Greece 800-353-12008, Italy 900-982-909, Netherlands

0800-0228919, Norway 800-10906, Russia  
810-800-20051353, Spain 900-982-909, Sweden  
020-792650, United Kingdom 0800-0569520

**FURTHER PROCEEDINGS.** Monster will determine whether a Product Defect existed. Monster may, at its discretion, direct You to obtain a repair estimate at a service center. If a repair estimate is required, You will be instructed on how to properly submit the estimate and the resulting invoice to Monster for payment. Any fees for repairs may be negotiated by Monster.

**TIMING.** If You bring a Formal Warranty Claim and fully comply with all terms and conditions of this Limited Warranty, Monster will use its best efforts to provide You with a remedy within thirty (30) days after receipt of Your Formal Warranty Claim (if You reside in the United States - forty-five (45) days if You reside elsewhere), unless obstacles outside Monster's control delay the process.





## **iCarCharger™ AUX 1000**

We invite you to visit the Monsters at **MonsterCable.com**

©2009 Monster Cable Products, Inc.  
455 Valley Drive Brisbane, CA 94005 USA  
1-877-800-8989

rm 195310